

INTRODUCTION

FLUID END ACCESSORIES

TSC's fluid end accessories are available for most of the popular triplex mud pumps. CNC machining renders these accessories uniformly dimensional and interchangeable with OEM. The perfect exterior surface reflects our superior quality.

Associated items

- Valve and cylinder head plug.
- Valve and cylinder head thread ring.
- Valve and cylinder head lock.
- Valve guide.
- Stud and nut.
- Specialty items.



FLUID END MODULE & ACCESSORIES

**TSC WF2000 (7500 PSI WORKING PRESSURE)
TSC Manufacturing and Supply, LLC.**

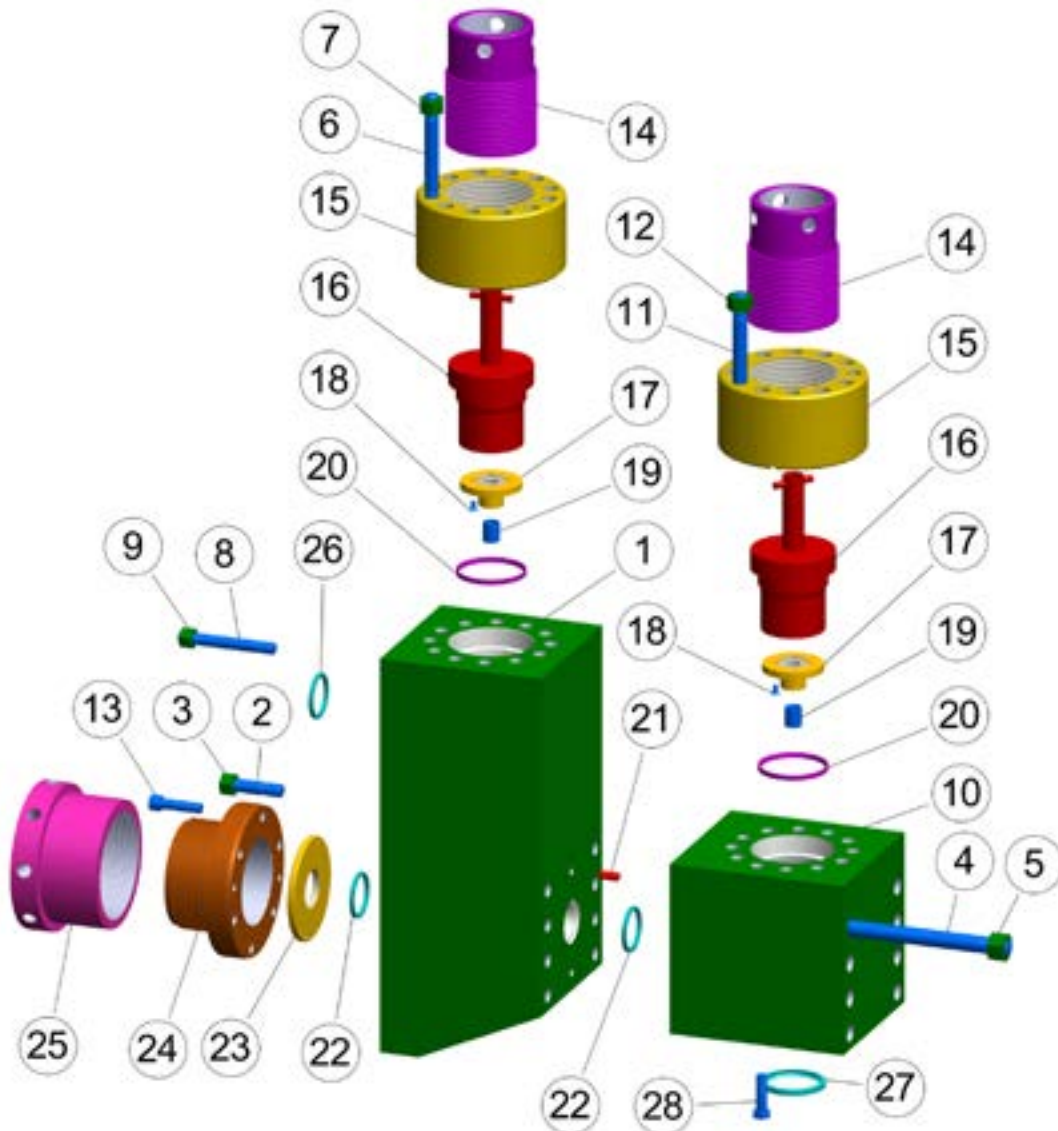

TSC Manufacturing and Supply LLC, 13788 West Road, Suite 100, Houston, Texas 77041, USA
Tel: +1 832 456 3900 Fax: +1 832 456 3998 E-mail: sales@t-s-c.com

FLUID END MODULE & ACCESSORIES**TSC WF2000 (7500 PSI WORKING PRESSURE)**

ITEM	PART NUMBER	DESCRIPTION	QTY/PUMP
	TS-80704032OE	FLUID END MODULE COMPLETE ASSEMBLY	3
1	TS-80704000	MODULE, DISCHARGE ONLY	3
2	TS-NAT12P160PFSSOE	STUD, POWER FRAME	30
3	TS-NAT8P80TRSN	NUT, POWER FRAME STUD	30
4	TS-80704002	STUD, DISCHARGE TO SUCTION MODULE	24
5	TS-PEP55	NUT, DISCHARGE TO SUCTION STUD	24
6	TS-80700014	STUD, THREADED RING	36
7	TS-6300240	NUT, THREADED RING STUD	36
8	TS-IDT800DMSOE	STUD, DISCHARGE MANIFOLD	12
9	TS-IDT800TRSN	NUT, DISCHARGE MANIFOLD STUD	12
10	TS-80704001	MODULE, SUCTION ONLY	3
11	TS-80700014	STUD, THREADED RING	36
12	TS-6300240	NUT, THREADED RING STUD	36
13	TS-PEP75	STUD, LINER BUSHING	18
14	TS-80704004	CAP, THREAD	6
15	TS-80704003	RING, THREAD	6
16	TS-80704005	VALVE COVER	6
17	TS-12PVGASW	VALVE GUIDE	6
18	TS-7007303	CAP SCREW, VALVE GUIDE	12
19	TS-2007674	BUSHING, VALVE GUIDE	6
20	P-129	SEAL, VALVE COVER	6
21	TS-6511416	PIN, DOWEL	6
22	TS-1290344	GASKET, WEAR PLATE AND LINER	6
23	TS-PP602160SW	WEAR LPATE	3
24	TS-12PLASW	FLANGE, LINER RETAINER (LINER BUSHING)	3
25	TS-12PLANSW	NUT, LINER RETAINER	3
26	TS-99609235	SEAL, DISCHARGE MANIFOLD	3
27	TS-1540851	GASKET, SUCTION MANIFOLD	3
28	TS-700048511	CAP SCREW, SUCTION MANIFOLD	24

TSC does not warrant or represent that any of such information is accurate, or that any products listed are compatible with each other.
Any deviations from the OEM products should be verified as to compatibility.