

## INTRODUCTION

### FLUID END ACCESSORIES

TSC's fluid end accessories are available for most of the popular triplex mud pumps. CNC machining renders these accessories uniformly dimensional and interchangeable with OEM. The perfect exterior surface reflects our superior quality.

#### Associated items

- Valve and cylinder head plug.
- Valve and cylinder head thread ring.
- Valve and cylinder head lock.
- Valve guide.
- Stud and nut.
- Specialty items.



## FLUID END MODULE & ACCESSORIES

### TSC WF2200 TSC Manufacturing and Supply, LLC.

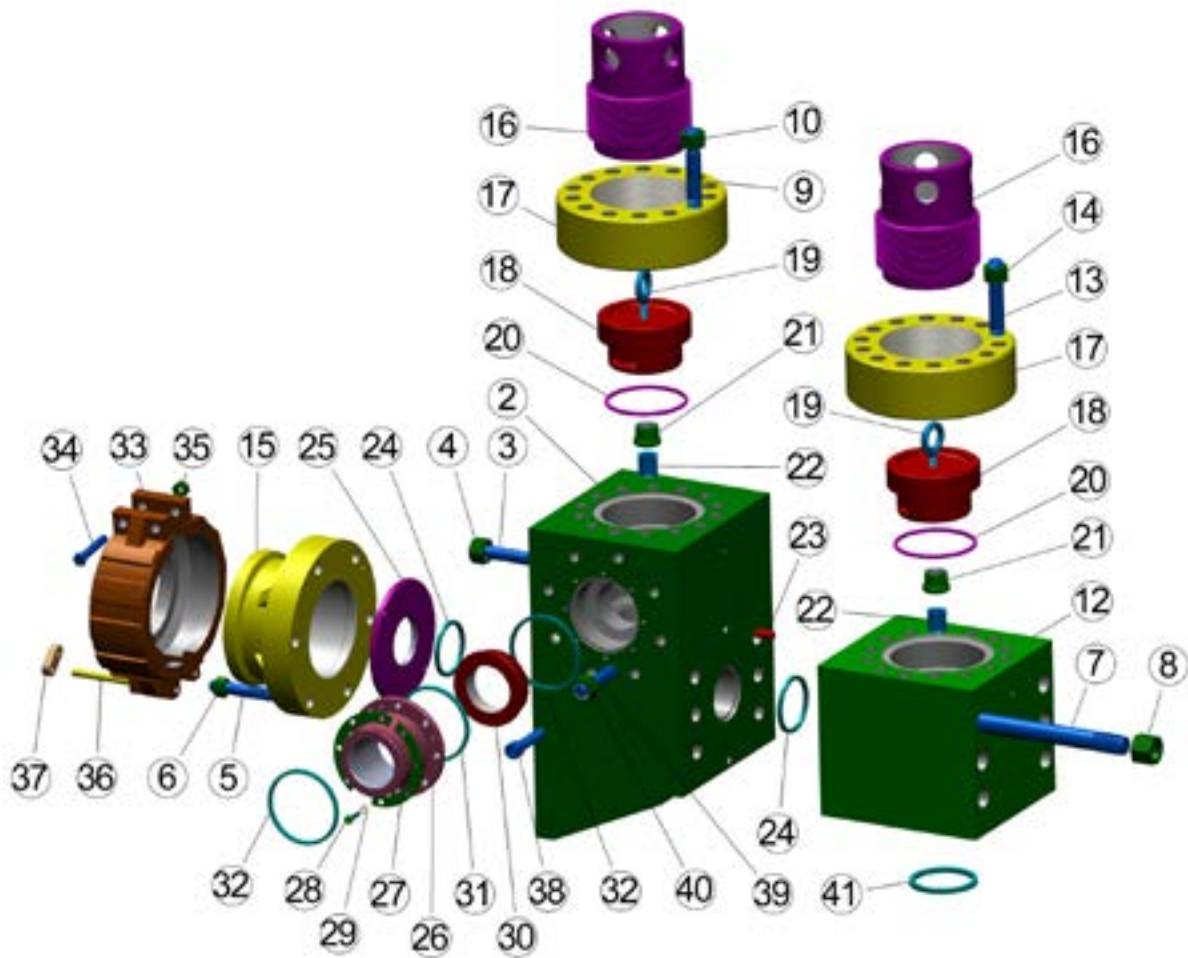

TSC Manufacturing and Supply LLC, 13788 West Road, Suite 100, Houston, Texas 77041, USA  
Tel: +1 832 456 3900 Fax: +1 832 456 3998 E-mail: sales@t-s-c.com

**FLUID END MODULE & ACCESSORIES****TSC WF2200**

| ITEM | PART NUMBER     | DESCRIPTION  | QTY/PUMP |
|------|-----------------|--|----------|
|      | TS-80718020     | ASSY, COMPLETE FLUID END W/ VALVE SERVICE & SUCTION MANIFOLD | 3        |
| 1    | TS-1295240      | MODULE, STUDED FLUID END DISCHARGE (INCLUDES ITEMS 2-10)     | 3        |
| 2    | TS-1295241      | DISCHARGE MODULE ONLY  | 3        |
| 3    | TS-2408027      | STUD, POWER FRAME  | 30       |
| 4    | TS-6300240      | NUT, POWER FRAME STUD  | 30       |
| 5    | TS-2408047      | STUD, LINER BUSHING  | 18       |
| 6    | TS-6300200      | NUT, LINER BUSHING STUD                                      | 18       |
| 7    | TS-2408048      | STUD, SUCTION TO DISCHARGE MODULE                            | 18       |
| 8    | TS-6300320      | NUT, SUCTION TO DISCHARGE MODULE STUD                        | 18       |
| 9    | TS-2408049      | STUD, VALVE COVER  | 42       |
| 10   | TS-6300240      | NUT, VALVE COVER STUD  | 42       |
| 11   | TS-1295243      | MODULE, STUDED FLUID END SUCTION (INCLUDES ITEMS 12-14)      | 3        |
| 12   | TS-1295244      | SUCTION MODULE ONLY  | 3        |
| 13   | TS-2408049      | STUD, VALVE COVER  | 42       |
| 14   | TS-6300240      | NUT, VALVE COVER STUD  | 42       |
| 15   | TS-1295165      | BUSHING, LINER   | 3        |
| 16   | TS-1295172      | CAP, VALVE COVER (THREADED)                                  | 6        |
| 17   | TS-1295176      | RING, THREADED   | 6        |
| 18   | TS-1295174      | RETAINER, SEAL   | 6        |
| 19   | TS-7601-0040-11 | PULLER, SEAL RETAINER  | 6        |
| 20   | TS-1540163      | SEAL, VALVE COVER  | 6        |
| 21   | TS-1292140      | HOLDER, VALVE GUIDE INSERT                                   | 6        |
| 22   | TS-1292141      | INSERT, VALVE GUIDE  | 6        |
| 23   | TS-6511416      | PIN, DOWELL  | 6        |
| 24   | TS-1295257      | SEAL, MODULE & WEAR PLATE                                    | 6        |
| 25   | TS-1295266      | PLATE, WEAR  | 3        |
| 26   | TS-1295252      | CONNECTOR, DISCHARGE   | 2        |
| 27   | TS-1295175      | RING, DISCHARGE CONNECTOR BACK UP                            | 4        |
| 28   | TS-700030711    | CAPSCREW, DISCHARGE CONNECTOR                                | 16       |
| 29   | TS-7619050      | WASHER, DISCHARGE CONNECTOR CAPSCREW                         | 16       |
| 30   | TS-1295253      | ADAPTER, DISCHARGE CONNECTOR                                 | 2        |
| 31   | TS-2410031438   | SEAL, DISCHARGE CONNECTOR TO DISCHARGE ADAPTER               | 2        |
| 32   | TS-2410031440   | SEAL, DISCHARGE CONNECTOR & DISCHARGE ADAPTER                | 4        |
| 33   | TS-1295166      | CLAMP COMPLETE, LINER  | 3        |
| 34   | TS-700049110    | CAPSCREW, LINER CLAMP  | 6        |
| 35   | TS-6309140      | NUT, LINER CAPSCREW  | 6        |
| 36   | TS-1295169      | PIN, LINER CLAMP   | 6        |
| 37   | TS-1295168      | CONNECTOR, LINER CLAMP                                       | 6        |
| 38   | TS-7006609      | CAPSCREW, DISCHARGE SPACER FLANGE                            | 24       |
| 39   | TS-2408014      | STUD, DISCHARGE FLANGE                                       | 24       |
| 40   | TS-6300180      | NUT, DISCHARGE FLANGE STUD                                   | 24       |
| 41   | TS-1540021      | SEAL, SUCTION MANIFOLD                                       | 3        |

TSC does not warrant or represent that any of such information is accurate, or that any products listed are compatible with each other.  
Any deviations from the OEM products should be verified as to compatibility.

TSC Manufacturing and Supply LLC, 13788 West Road, Suite 100, Houston, Texas 77041, USA  
Tel: +1 832 456 3900 Fax: +1 832 456 3998 E-mail: sales@t-s-c.com